



# Capital Project Input Forum 2019

# Background

- Architects were RFP'd in late summer/fall 2018 for budget approved capital outlay project/upcoming BCS
- Building walkthrough in October 2018 with new architects, BOE
- Conceptual ideas from architects were requested

# Current Possibilities

## Main Areas

- Cafeteria consolidation/building connection
- Library consolidation
- Room renovation/reconstruction

## Additional Areas for Consideration

- Auditorium entry
- Playground
- Stadium field/track
- Additional athletic field renovations
- Parking lot renovation and refurbishment
- Courtyard renovation

# Cafeteria/Library Concept A

Concept would be to design a large group/community area that would be multifunctional for large group gatherings, large group instruction, and separated seating and serving for student lunches. This concept shows the consolidated library at the front of the current middle school loop but could be moved allowing for classrooms in the blue area.

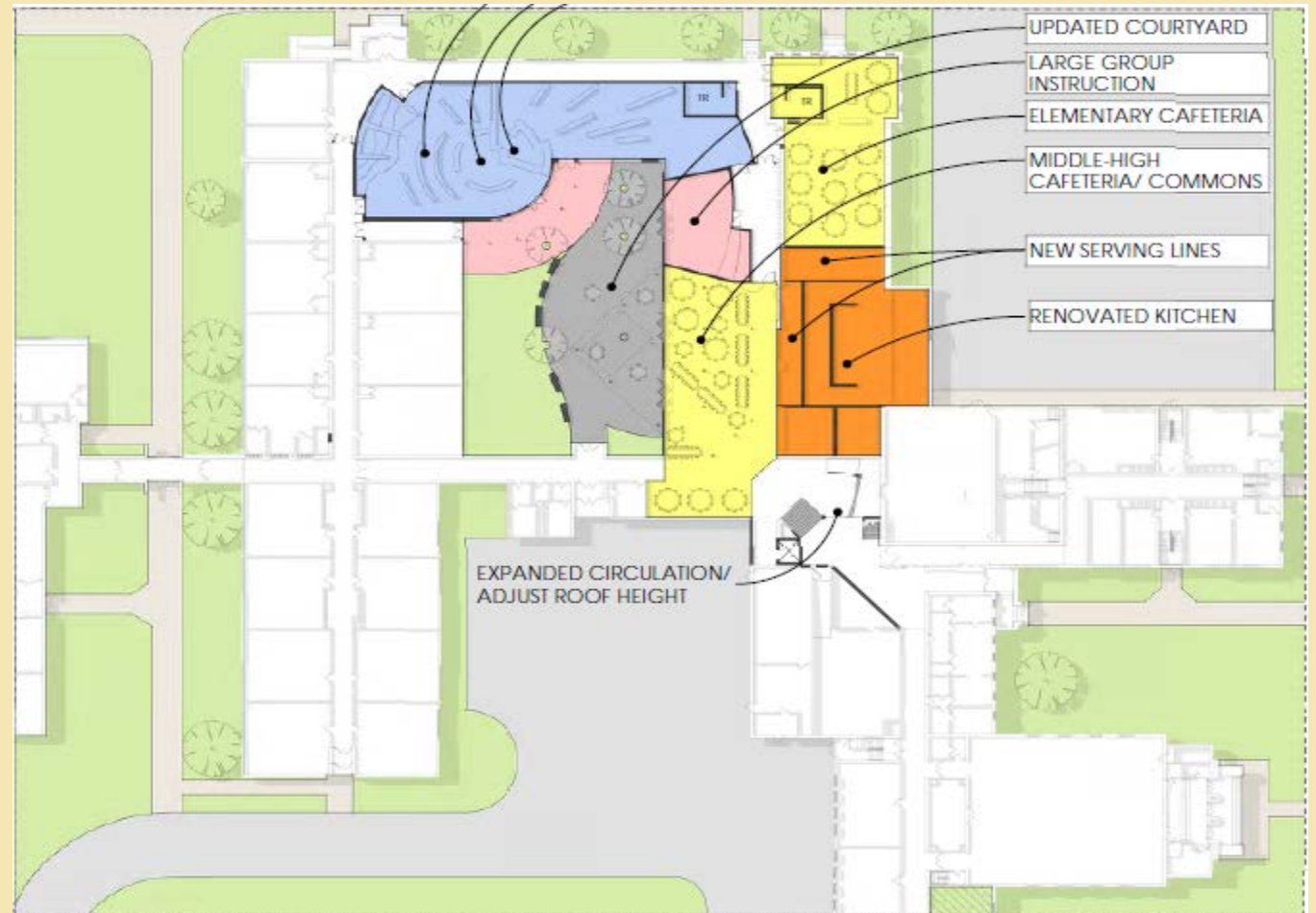

# Library Concept A

\$3 Million

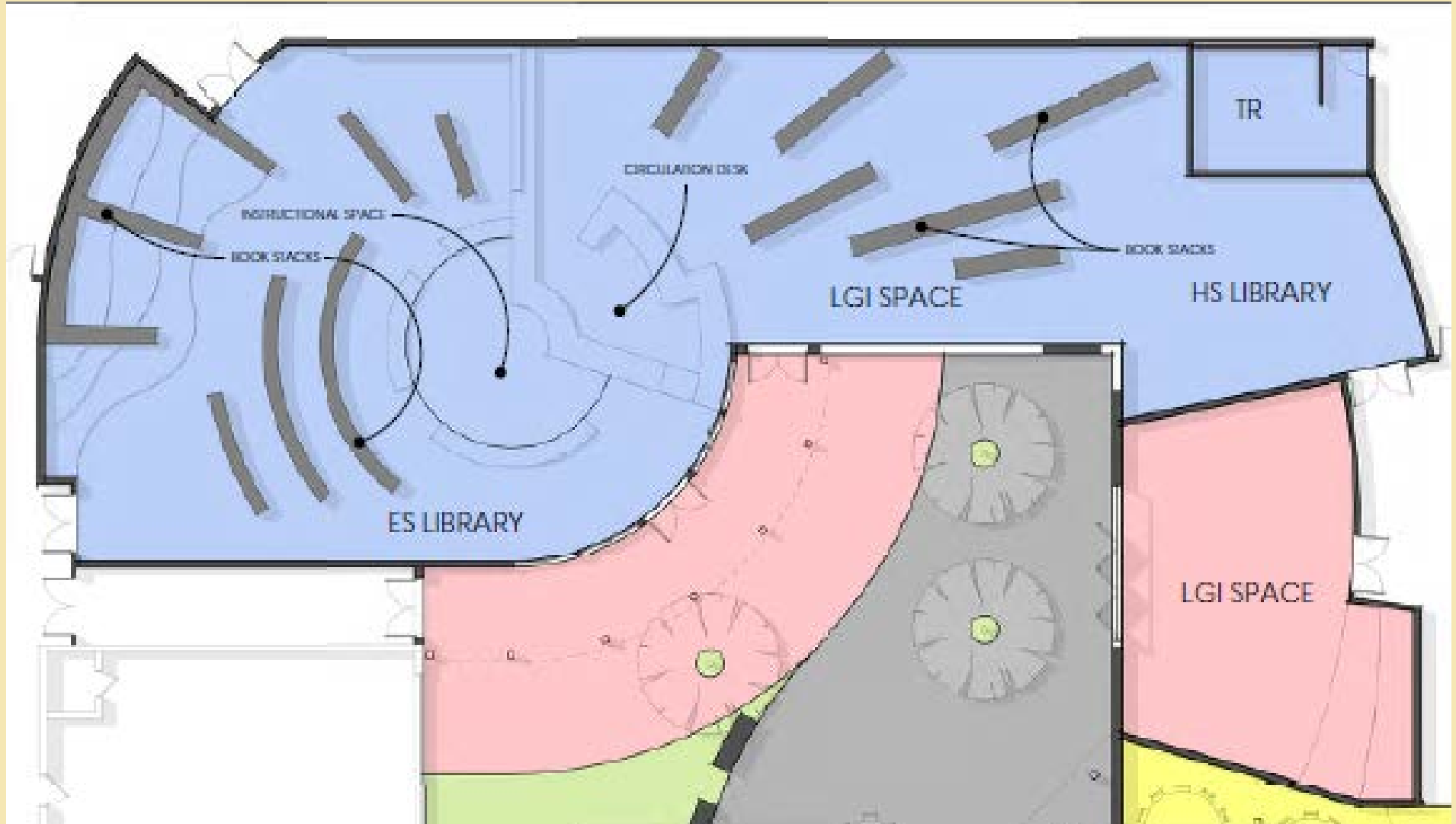

# Cafeteria Concept A

\$2.7 Million



# Cafeteria/Library Concept A

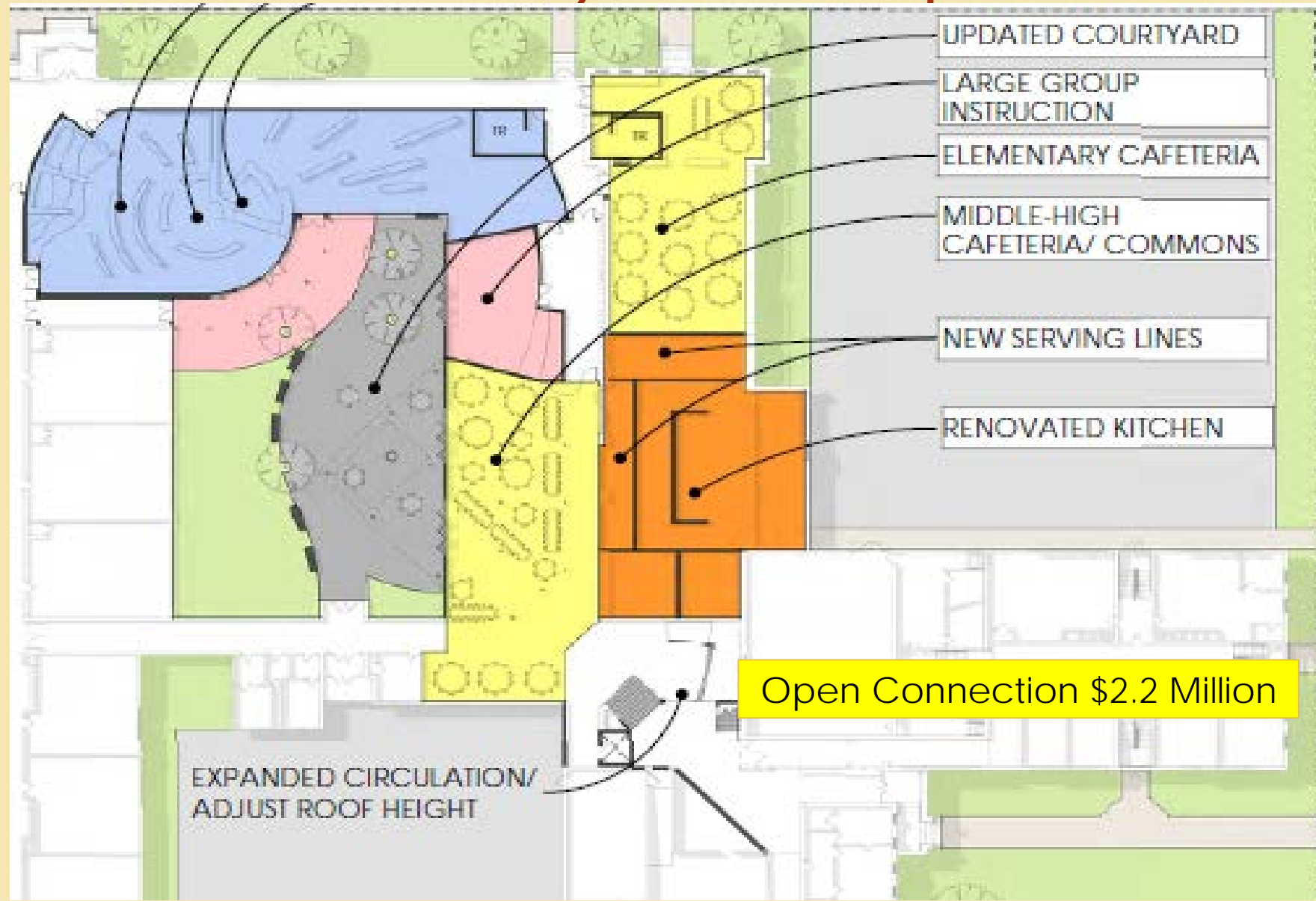

# Library Concept B

\$2 Million



HS LIBRARY SPACES



INDOOR/ OUTDOOR LEARNING SPACE



# Cafeteria Concept B

\$2.2 Million

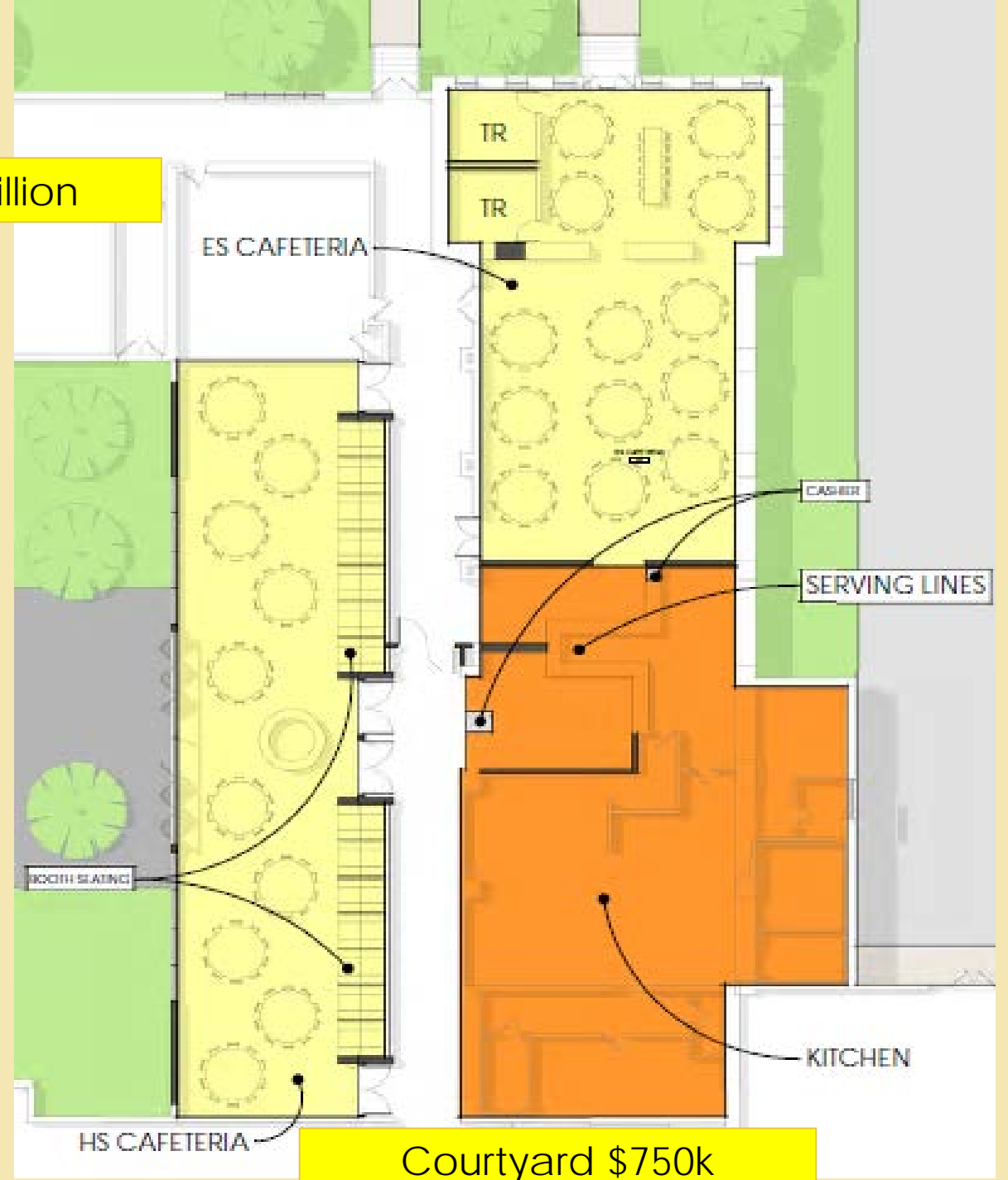
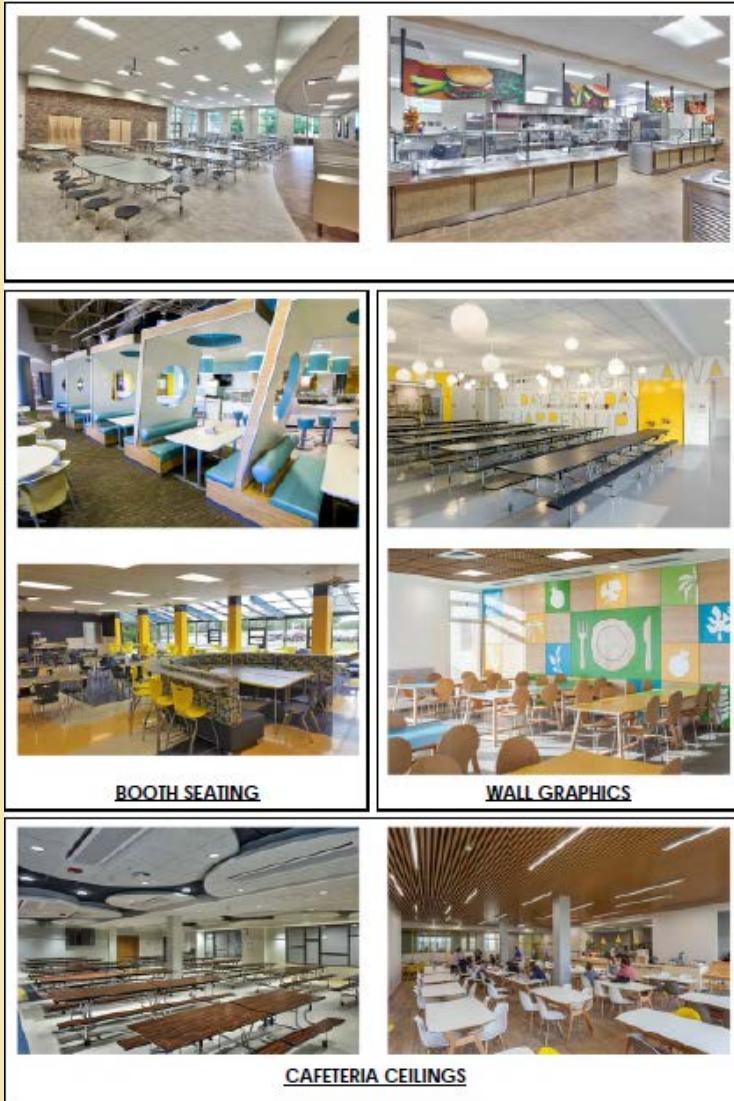

# Cafeteria/Library Concept B



# Auditorium

\$750,000

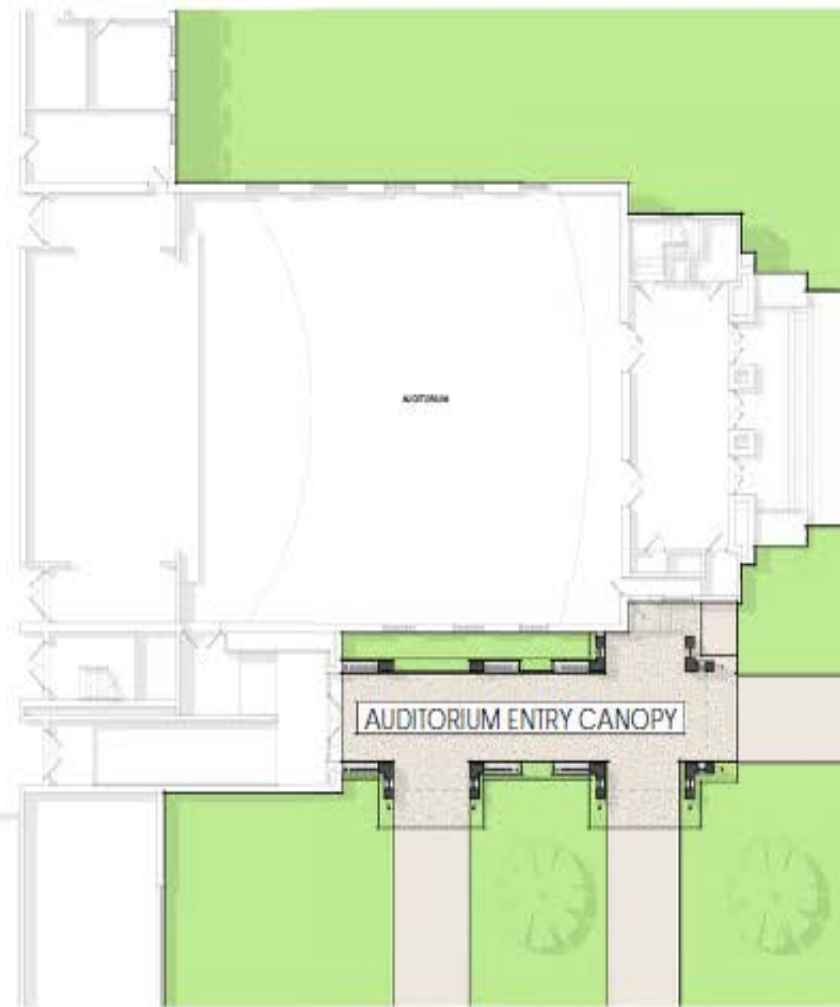

PARTIAL FLOOR PLAN - AUDITORIUM ENTRY

3/32" = 1'-0"



AUDITORIUM ENTRY CANOPY CONCEPT

# Field, Parking Lots, and Playground

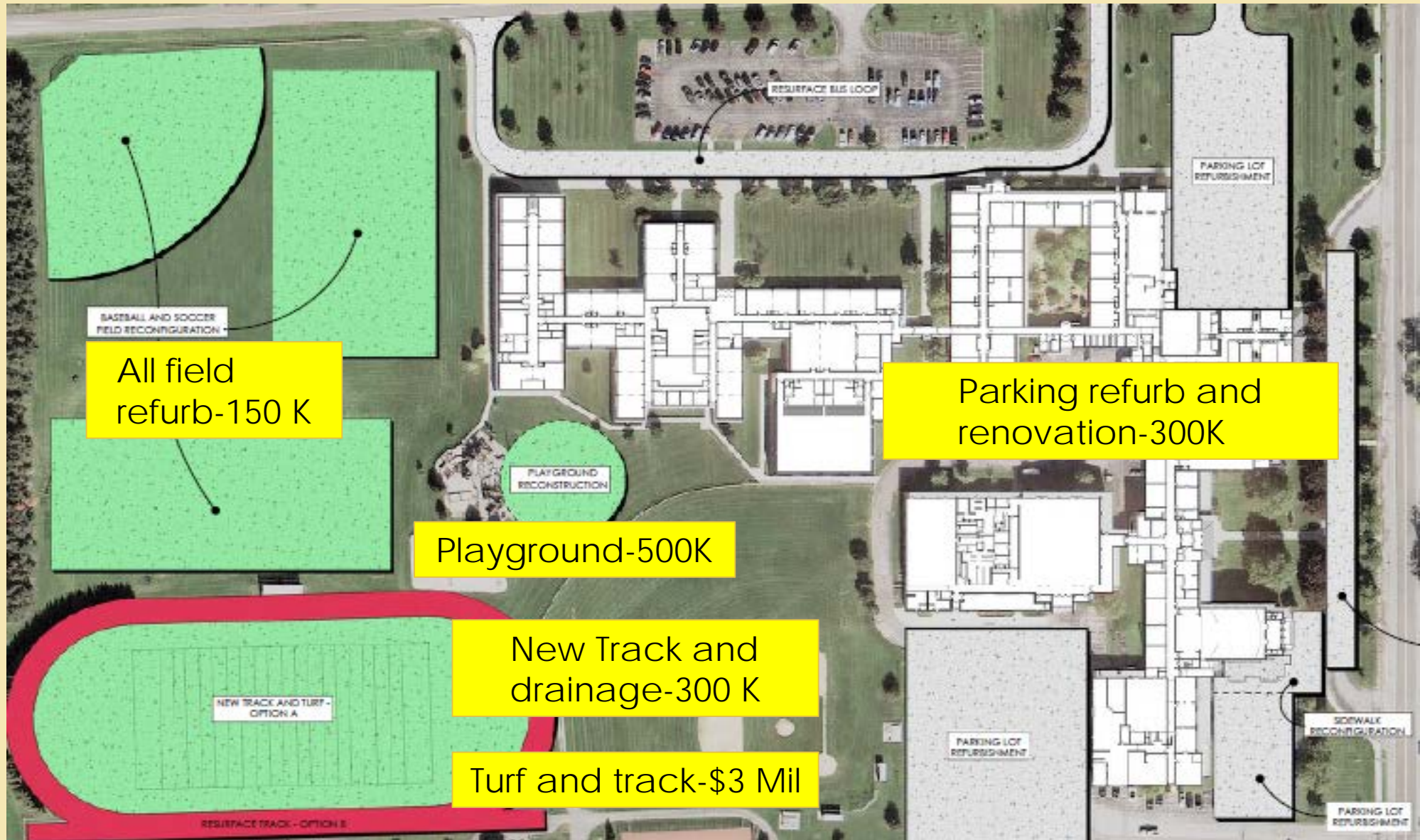

# Funding

State Building Aid Ratio for  
Barker ~ 88%

\$4,000,000 Project  
amortized at approximately  
4% over 15 years

Annual costs would be  
approximately  
\$355,050

Annual State Building Aid  
~ \$312,445

Annual Reserve  
Use/Budgetary Allocation  
~ \$42,605

NO impact on current tax  
rate or levy

\$8,500,000 Project  
amortized at approximately  
4% over 15 years

Annual costs would be  
approximately  
\$754,500

Annual State Building Aid  
~ \$663,960

Annual Reserve  
Use/Budgetary Allocation  
~ \$90,540

NO impact on current tax  
rate or levy

\$13,600,000 Project  
amortized at approximately  
4% over 15 years

Annual costs would be  
approximately  
\$1,207,150

Annual State Building Aid  
~ \$1,062,295

Annual Reserve  
Use/Budgetary Allocation  
~ \$144,855

NO impact on current tax  
rate or levy

# Possible Timeline

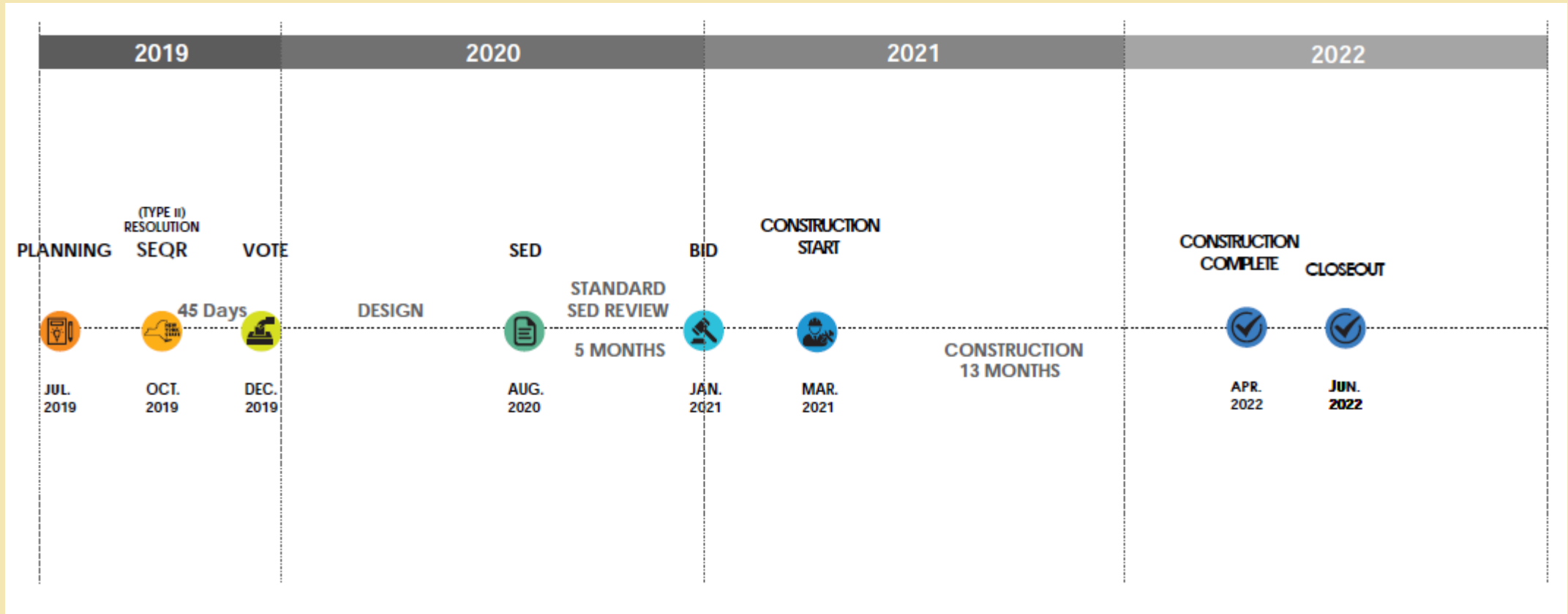

# Capital Project Survey

[https://docs.google.com/forms/d/e/1FAIpQLSenn5Z-ISa0sIBlxERLE3rxa46YJkDYc2qd73So6X2Anqj1ug/viewform?usp=sf\\_link](https://docs.google.com/forms/d/e/1FAIpQLSenn5Z-ISa0sIBlxERLE3rxa46YJkDYc2qd73So6X2Anqj1ug/viewform?usp=sf_link)